

Welding Table / Bench

Plans Book

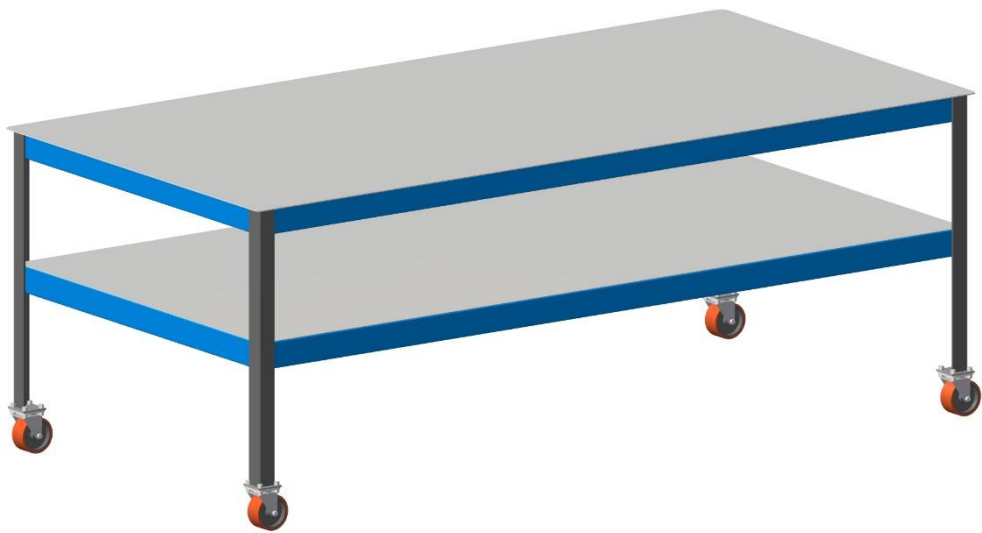

Kurraglen Industries
PO Box 215
Gulgong, NSW, 2852
Australia

<https://www.kurraglenindustries.com.au>

sales@kurraglenindustries.com.au

<https://www.facebook.com/kurraglen/>



Welding Table

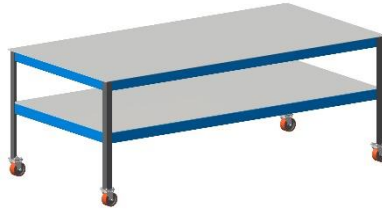

This welding table is the perfect solution to build many of our projects. You may wish to change the overall size of the table to suit your own needs. The suggested dimensions of the table are: 2400mm long x 1200mm wide by approximately 900mm high.

Tools required include a welder, either stick or mig, G clamps or welding clamps, tape measure, angle grinder for cutting and cleaning up welds, electric drill and a square. You may buy lengths of steel and cut it to the correct sizes if you have either an angle grinder or electric bandsaw or you may choose to have the steel cut for you from a local steel supplier. One thing that will make your job a lot easier is to construct a pair of welding trestles as shown on our website (www.kurraglenindustries.com.au). The plans for the welding trestles are free.

To make the best use out of your lengths of steel, we have a free-to-use Cutting List Optimiser on our website. Visit <https://www.kurraglenindustries.com.au/linear-cutting-list-calculator.htm>

The following steel and materials are required to build the welding table:

75x50x2 RHS – 3 lengths @ 8 metre	3mm black sheet – 1200 x 2400mm
50x50x5 angle – approx. 4 metres	1.5mm black sheet – 1200 x 2400mm
Flat bar to suit your caster wheels.	Caster wheels – 4
Bolts and nuts for mounting the caster wheels	

Cutting List for the Welding Table				
Item No	Quantity	Material	Size (mm)	Notes
1	4	75x50x2 RHS	2350	45 degree angle both ends
2	4	75x50x2 RHS	1150	45 degree angle both ends
3	6	75x50x2 RHS	1050	
4	4	50x50x5 angle	775	See note below

Note: Length of angle length is based on having a finished height of approximately 900mm. Check the overall height of the caster wheels that you intend to use and adjust the length of the angle to suit your desired height.

1. Begin by cutting all of the steel as indicated in the cutting list. Label each with the item number on it using a marking pen and set aside. Make sure that the angles on items 1 and 2 are cut as shown in diagram 1.
2. Layout two of items 1, two of items 2 and three of items 3. Ensure that the frame is square and tack weld all items. Recheck for square and fully weld. Refer to diagram 1.

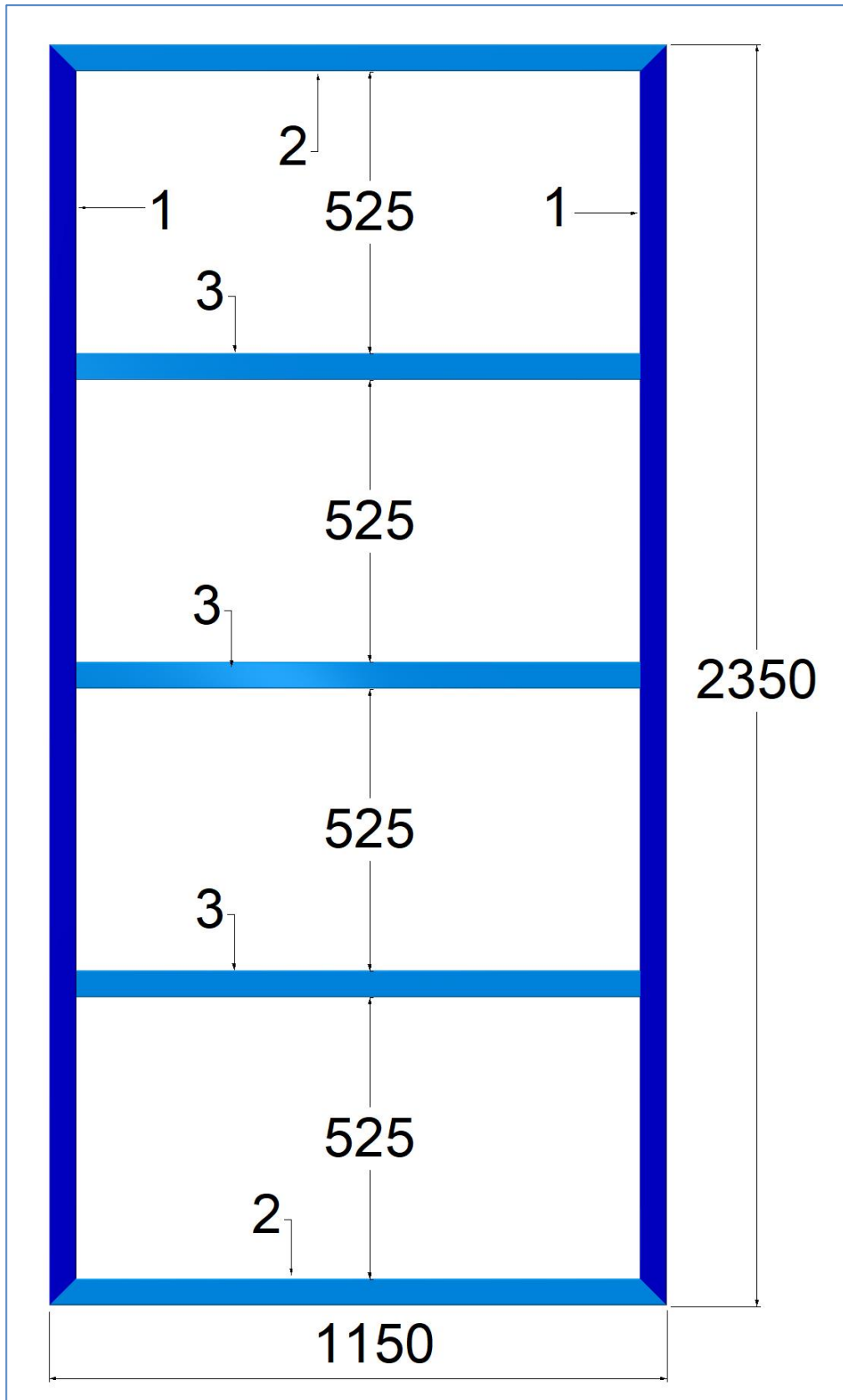

Diagram 1

3. Repeat the above step for the lower frame.
4. Position one of the lengths of angle (item 4) at each of the corners on one of the frames. Place a few decent tack welds to hold them in position whilst completing the next step. The ends of the angle need to be flush with the top face of the upper frame. Refer to diagram 2.

5. Turn the assembly onto its side. Mark about halfway down the angle (or wherever you wish the shelf frame to be) and position the lower frame inside the four pieces of angle. Tack weld into place.
6. Check that the angle legs are square to the frames and fully weld.

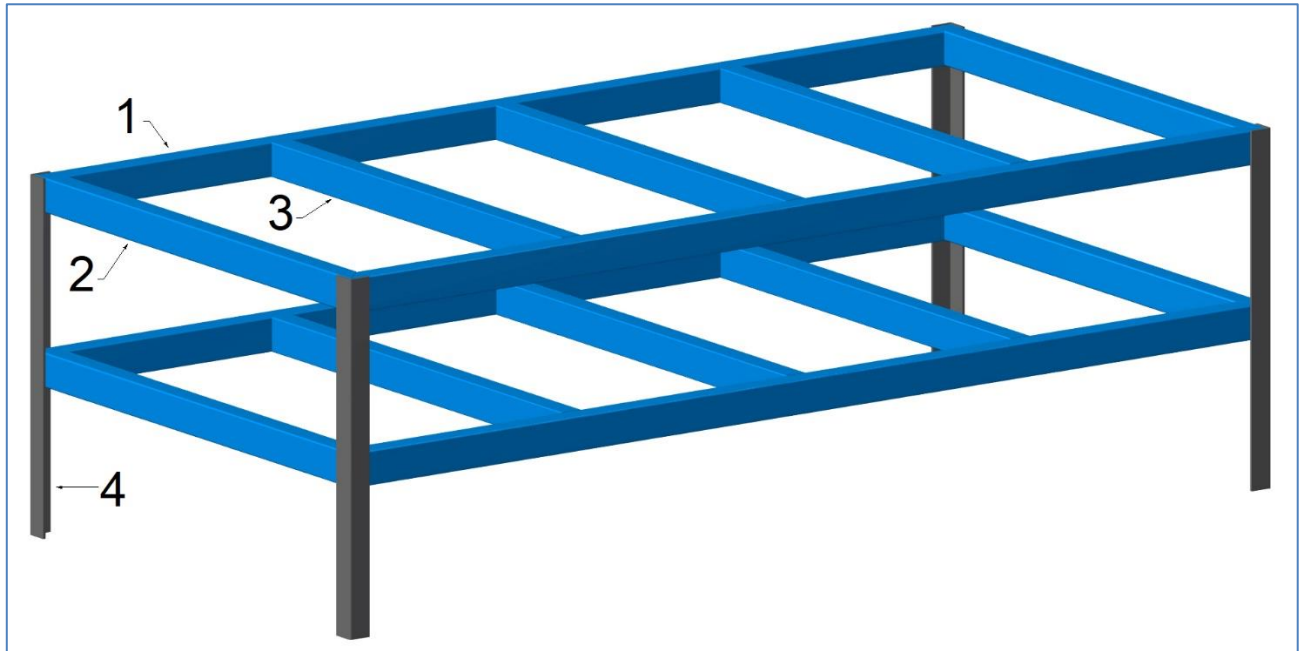

Diagram 2

7. Cut flat bar to suit your caster wheels and drill mounting holes as required.
8. Weld the caster wheel mounting plates to the ends of the angle legs and install the caster wheels. See diagram 3 for an example.

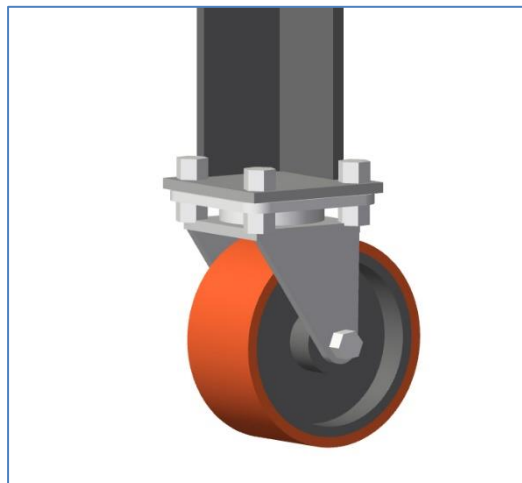

Diagram 3

9. Cut the 1.5mm black sheet for the shelf as shown in diagram 4.

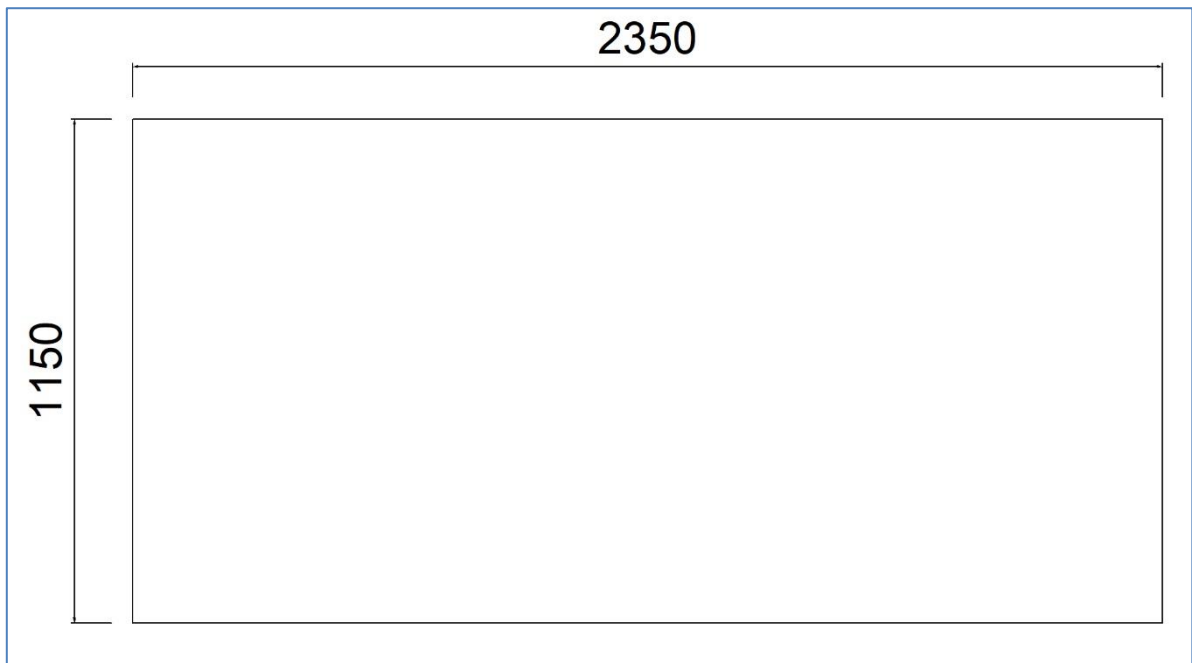

Diagram 4

10. Position the previously cut sheet in position on the lower frame and place small welds approximately 300-400mm apart underneath the sheet to secure it to the frame.
11. Repeat the previous step for the 3mm sheet for the top of the welding table.
12. Using an angle grinder with a cutting disc fitted, cut a small radius on each corner of the top sheet so that there are no sharp corners.
13. Clean any welds using a grinding disc or flap disc and paint the frame as required.

If you have any problems or issues and need assistance, we are here to help. Send an email to help@kurraglenindustries.com.au

Proud of your project? Email us the photos of your equipment or yards that you have made from our books and we will put them up on our website for others to admire. You can even be in the photo if you would like to be. Be sure that you include your name, where you are from and a brief description. Please make sure that the photos are of good quality, in jpg (jpeg) or png format, at least 72 dpi and at least 900 pixels by 600 pixels. Email your photos to: projects@kurraglenindustries.com.au